

**TRAFFIC MANAGEMENT NOTES:**

1. ALL PAVEMENT MARKING AND SIGNPOSTING TO BE IN ACCORDANCE WITH ROADS AND MARITIME SERVICES SUPPLEMENTS, RMS DELINEATION MANUAL, AUSTRROADS GUIDES, AUSTRALIAN STANDARDS (AS1742) AND RMS SPECIFICATIONS R141 AND R143.
2. ALL RETROREFLECTIVE RAISED PAVEMENT MARKERS TO BE IN ACCORDANCE WITH RMS SPECIFICATION R142 AND "RMS DELINEATION" SECTION 15 – RAISED PAVEMENT MARKERS.
3. ALL CONCRETE ISLAND KERB FACES ARE TO BE PAINTED WITH APPROVED REFLECTIVE WHITE PAINT IN ACCORDANCE WITH RMS SPECIFICATION R141.
4. STREET SIGNS TO BE PLACED AS DIRECTED BY SUPERVISING ENGINEER.
5. ENSURE ALL SIGNPOSTS ARE PLACED CLEAR OF EXISTING OR PROPOSED DRIVEWAYS AND CLEAR OF TREES AND OTHER STREET FURNITURE.
6. TRAFFIC CONTROL MEASURES ARE TO BE CARRIED OUT PRIOR, DURING AND AFTER CONSTRUCTION IN ACCORDANCE WITH A.S.1742.3
7. ALL PAVEMENT MARKING AND SIGNPOSTING IS TO BE APPROVED BY CITY OF PARRAMATTA COUNCIL TRAFFIC ENGINEER.
8. ALL SIGN POSTS IN CONCRETE TO BE HELD IN POSITION WITH V-LOCKS.
9. ALL PAINTWORK TO BE COMPLETED ON DAY OF INSTALLATION.
10. ALL LINEMARKING TO BE APPROVED WHITE THERMOPLASTIC PAINT.
11. ALL REDUNDANT SIGNS AND LINEMARKING WITHIN LIMIT OF WORKS TO BE REMOVED AS REQUIRED. RECOVERED POSTS TO BE REUSED IF PRACTICABLE.
12. ALL "TB", "TF" HOLDING LINES TO BE 300mm WIDE UNLESS NOTED OTHERWISE. REFER TO "RMS DELINEATION" SECTION 6 – TRANSVERSE MARKINGS

**NOTE:**  
 REPAINT FADED OR DAMAGED LINEMARKING AND RRPMS AS REQUIRED OUTSIDE OF SCOPE.  
 REMOVE ALL SIGNS WITHIN SCOPE IN CONFLICT WITH PROPOSED WORKS.

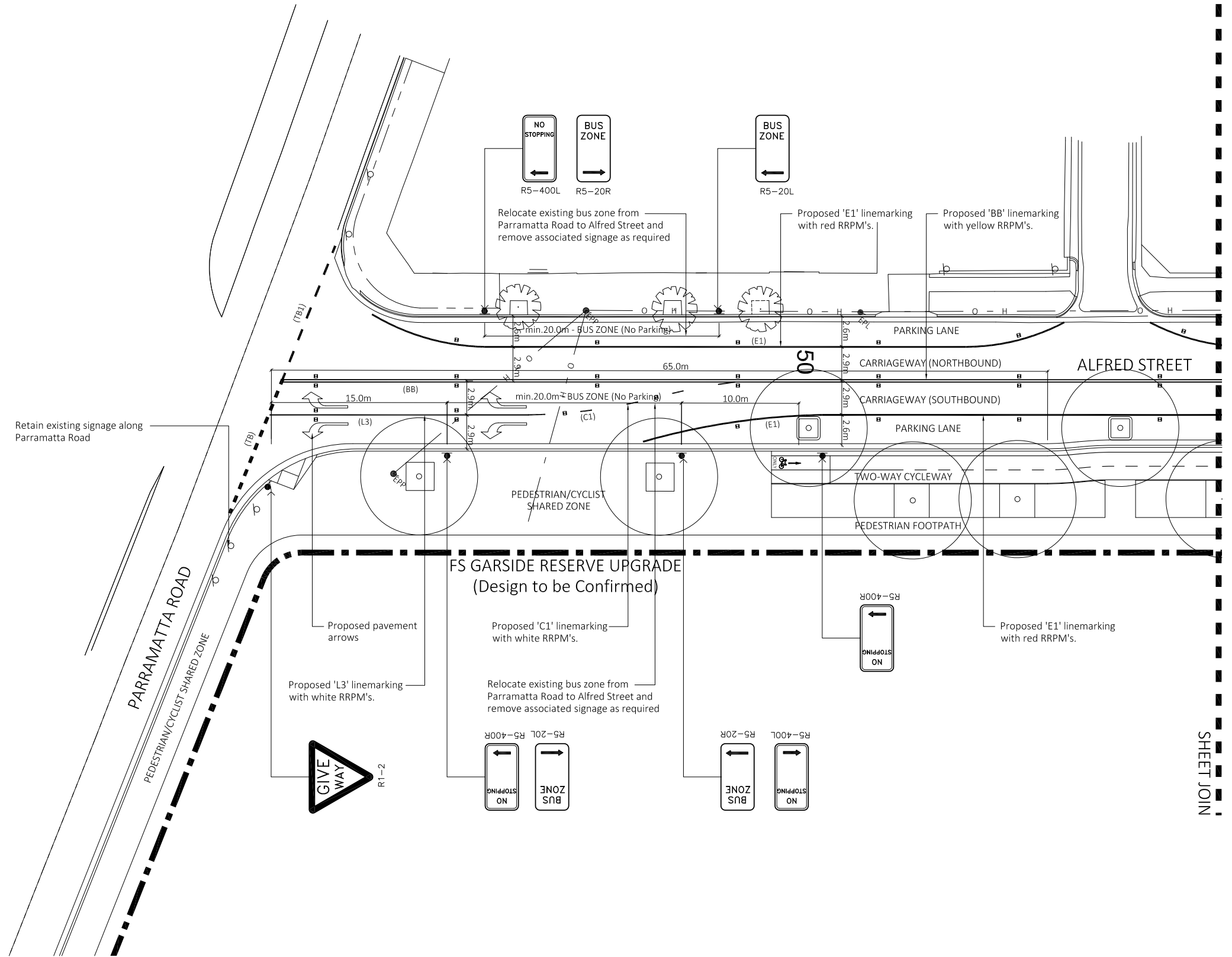

SHEET JOIN



Issue:	Date:	Description:	 Co-ords: MGA Datum: AHD	Designed: JG Date:	Client Accepted: Date:	Date: 18th June 2020	Project: ALFRED STREET CYCLEWAY STAGE 1 & 2 GRANVILLE Title: TRAFFIC MANAGEMENT PLAN	Plan No: 17749
				Drawn: JG Date:	Approved for Construction: Date:	Scale: 1:200 @ A1		Sheet No: 1 of 6
			UNLESS DETAILED ON THIS DRAWING ALL WORK SHALL CONFORM TO	Design Approved: Date:	Service Manager Capital Projects	Drawing Status: FINAL	Revision: B	

**TRAFFIC MANAGEMENT NOTES:**

1. ALL PAVEMENT MARKING AND SIGNPOSTING TO BE IN ACCORDANCE WITH ROADS AND MARITIME SERVICES SUPPLEMENTS, RMS DELINEATION MANUAL, AUSTRROADS GUIDES, AUSTRALIAN STANDARDS (AS1742) AND RMS SPECIFICATIONS R141 AND R143.
2. ALL RETROREFLECTIVE RAISED PAVEMENT MARKERS TO BE IN ACCORDANCE WITH RMS SPECIFICATION R142 AND "RMS DELINEATION" SECTION 15 - RAISED PAVEMENT MARKERS.
3. ALL CONCRETE ISLAND KERB FACES ARE TO BE PAINTED WITH APPROVED REFLECTIVE WHITE PAINT IN ACCORDANCE WITH RMS SPECIFICATION R141.
4. STREET SIGNS TO BE PLACED AS DIRECTED BY SUPERVISING ENGINEER.
5. ENSURE ALL SIGNPOSTS ARE PLACED CLEAR OF EXISTING OR PROPOSED DRIVEWAYS AND CLEAR OF TREES AND OTHER STREET FURNITURE.
6. TRAFFIC CONTROL MEASURES ARE TO BE CARRIED OUT PRIOR, DURING AND AFTER CONSTRUCTION IN ACCORDANCE WITH A.S.1742.3
7. ALL PAVEMENT MARKING AND SIGNPOSTING IS TO BE APPROVED BY CITY OF PARRAMATTA COUNCIL TRAFFIC ENGINEER.
8. ALL SIGN POSTS IN CONCRETE TO BE HELD IN POSITION WITH V-LOCKS.
9. ALL PAINTWORK TO BE COMPLETED ON DAY OF INSTALLATION.
10. ALL LINEMARKING TO BE APPROVED WHITE THERMOPLASTIC PAINT.
11. ALL REDUNDANT SIGNS AND LINEMARKING WITHIN LIMIT OF WORKS TO BE REMOVED AS REQUIRED. RECOVERED POSTS TO BE REUSED IF PRACTICABLE.
12. ALL "TB", "TF" HOLDING LINES TO BE 300mm WIDE UNLESS NOTED OTHERWISE. REFER TO "RMS DELINEATION" SECTION 6 - TRANSVERSE MARKINGS

**NOTE:**  
 REPAINT FADED OR DAMAGED LINEMARKING AND RRPM'S AS REQUIRED OUTSIDE OF SCOPE.  
 REMOVE ALL SIGNS WITHIN SCOPE IN CONFLICT WITH PROPOSED WORKS.

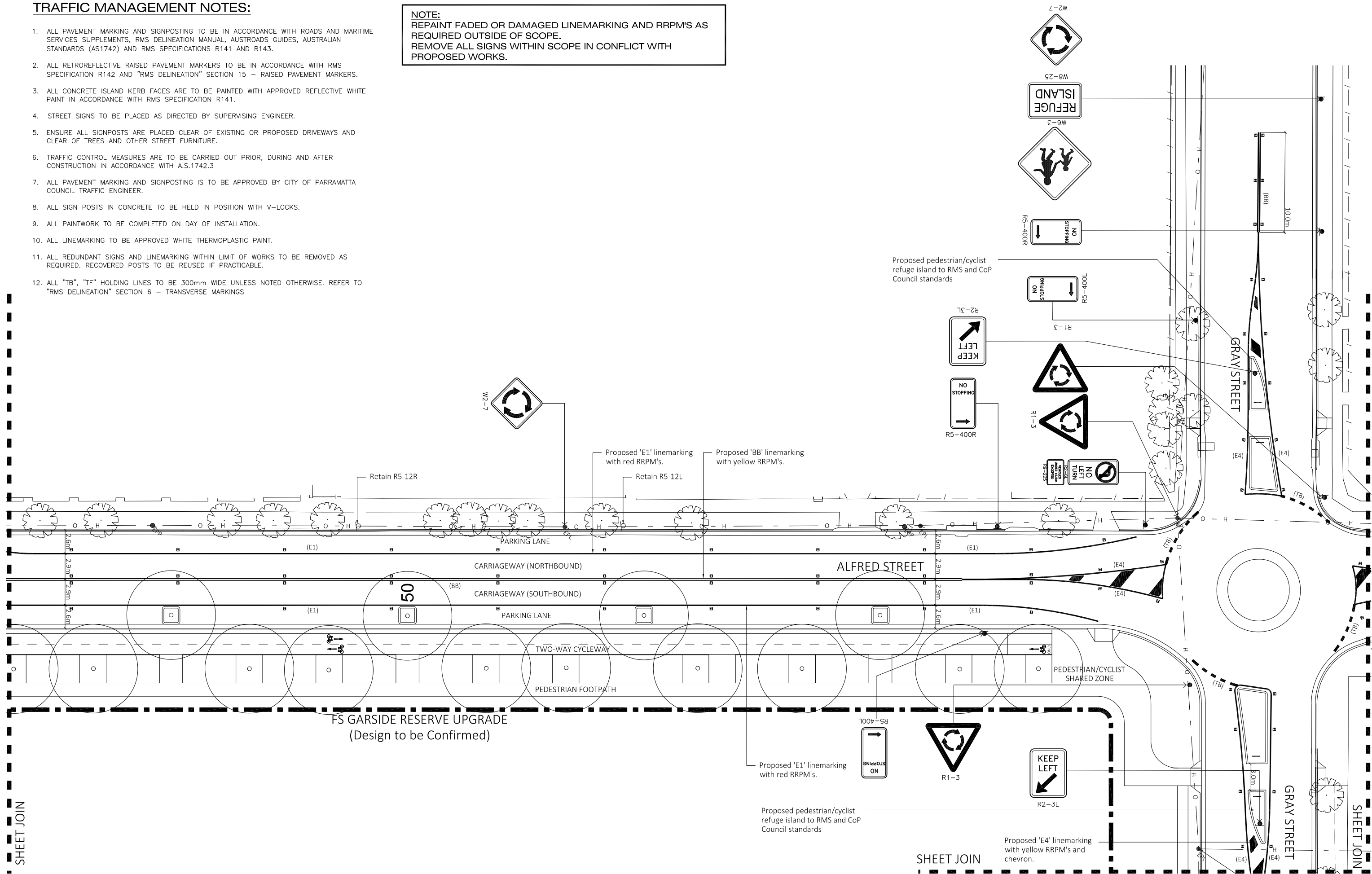

Issue:	Date:	Description:

Scale: 0 1 5 10 15m

Co-ords: MGA Datum: AHD

AUS SPEC UNLESS DETAILED ON THIS DRAWING ALL WORK SHALL CONFORM TO

Designed: JG Date:	Client Accepted:
Drawn: JG Date:	Approved for Construction:
Design Approved:	Service Manager Capital Projects

Date: 18th June 2020
Scale: 1:200 @ A1
Drawing Status: FINAL

Project: ALFRED STREET CYCLEWAY STAGE 1 & 2 GRANVILLE
Title: TRAFFIC MANAGEMENT PLAN

Plan No: 17749
Sheet No: 2 of 6
Revision: B

DIAL 1100 BEFORE YOU DIG

**NOTE:**  
 REPAINT FADED OR DAMAGED LINEMARKING AND RRPM'S AS REQUIRED OUTSIDE OF SCOPE.  
 REMOVE ALL SIGNS WITHIN SCOPE IN CONFLICT WITH PROPOSED WORKS.

**TRAFFIC MANAGEMENT NOTES:**

1. ALL PAVEMENT MARKING AND SIGNPOSTING TO BE IN ACCORDANCE WITH ROADS AND MARITIME SERVICES SUPPLEMENTS, RMS DELINEATION MANUAL, AUSTRROADS GUIDES, AUSTRALIAN STANDARDS (AS1742) AND RMS SPECIFICATIONS R141 AND R143.
2. ALL RETROREFLECTIVE RAISED PAVEMENT MARKERS TO BE IN ACCORDANCE WITH RMS SPECIFICATION R142 AND "RMS DELINEATION" SECTION 15 - RAISED PAVEMENT MARKERS.
3. ALL CONCRETE ISLAND KERB FACES ARE TO BE PAINTED WITH APPROVED REFLECTIVE WHITE PAINT IN ACCORDANCE WITH RMS SPECIFICATION R141.
4. STREET SIGNS TO BE PLACED AS DIRECTED BY SUPERVISING ENGINEER.
5. ENSURE ALL SIGNPOSTS ARE PLACED CLEAR OF EXISTING OR PROPOSED DRIVEWAYS AND CLEAR OF TREES AND OTHER STREET FURNITURE.
6. TRAFFIC CONTROL MEASURES ARE TO BE CARRIED OUT PRIOR, DURING AND AFTER CONSTRUCTION IN ACCORDANCE WITH A.S.1742.3
7. ALL PAVEMENT MARKING AND SIGNPOSTING IS TO BE APPROVED BY CITY OF PARRAMATTA COUNCIL TRAFFIC ENGINEER.
8. ALL SIGN POSTS IN CONCRETE TO BE HELD IN POSITION WITH V-LOCKS.
9. ALL PAINTWORK TO BE COMPLETED ON DAY OF INSTALLATION.
10. ALL LINEMARKING TO BE APPROVED WHITE THERMOPLASTIC PAINT.
11. ALL REDUNDANT SIGNS AND LINEMARKING WITHIN LIMIT OF WORKS TO BE REMOVED AS REQUIRED. RECOVERED POSTS TO BE REUSED IF PRACTICABLE.
12. ALL "TB", "TF" HOLDING LINES TO BE 300mm WIDE UNLESS NOTED OTHERWISE. REFER TO "RMS DELINEATION" SECTION 6 - TRANSVERSE MARKINGS

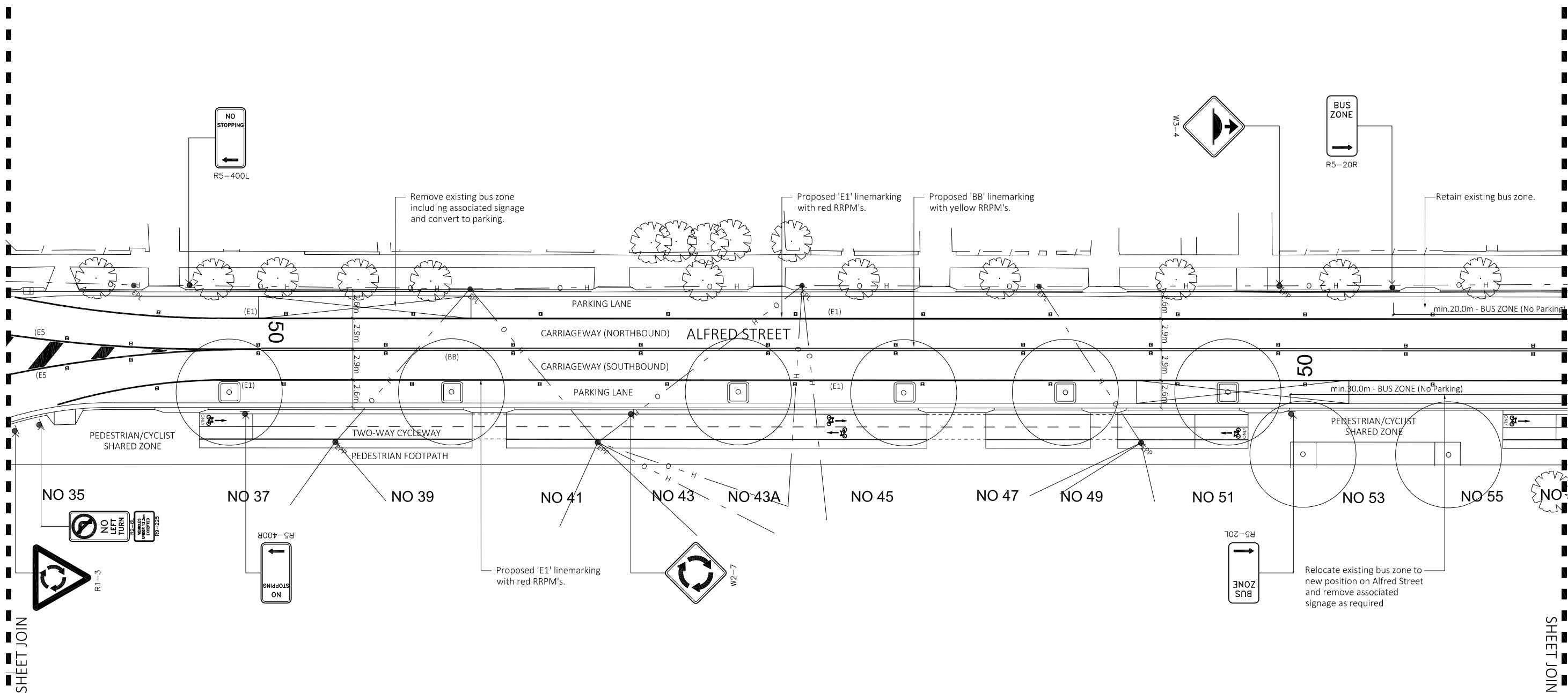

Issue:	Date:	Description:

Co-ords:	Datum:
MGA	AHD
UNLESS DETAILED ON THIS DRAWING ALL WORK SHALL CONFORM TO	

Designed:	Date:	Client Accepted:	Date:
JG			
Drawn:	Date:	Approved for Construction:	Date:
JG			
Design Approved:	Date:	Service Manager Capital Projects	

Date:	18th June 2020
Scale:	1:200 @ A1
Drawing Status:	FINAL

Project:	ALFRED STREET CYCLEWAY STAGE 1 & 2 GRANVILLE
Title:	TRAFFIC MANAGEMENT PLAN

Plan No:	17749
Sheet No:	3 of 6
Revision:	B

**NOTE:**  
 REPAIR FADED OR DAMAGED LINEMARKING AND RRPM'S AS REQUIRED OUTSIDE OF SCOPE.  
 REMOVE ALL SIGNS WITHIN SCOPE IN CONFLICT WITH PROPOSED WORKS.

**TRAFFIC MANAGEMENT NOTES:**

1. ALL PAVEMENT MARKING AND SIGNPOSTING TO BE IN ACCORDANCE WITH ROADS AND MARITIME SERVICES SUPPLEMENTS, RMS DELINEATION MANUAL, AUSTRROADS GUIDES, AUSTRALIAN STANDARDS (AS1742) AND RMS SPECIFICATIONS R141 AND R143.
2. ALL RETROREFLECTIVE RAISED PAVEMENT MARKERS TO BE IN ACCORDANCE WITH RMS SPECIFICATION R142 AND "RMS DELINEATION" SECTION 15 - RAISED PAVEMENT MARKERS.
3. ALL CONCRETE ISLAND KERB FACES ARE TO BE PAINTED WITH APPROVED REFLECTIVE WHITE PAINT IN ACCORDANCE WITH RMS SPECIFICATION R141.
4. STREET SIGNS TO BE PLACED AS DIRECTED BY SUPERVISING ENGINEER.
5. ENSURE ALL SIGNPOSTS ARE PLACED CLEAR OF EXISTING OR PROPOSED DRIVEWAYS AND CLEAR OF TREES AND OTHER STREET FURNITURE.
6. TRAFFIC CONTROL MEASURES ARE TO BE CARRIED OUT PRIOR, DURING AND AFTER CONSTRUCTION IN ACCORDANCE WITH A.S.1742.3
7. ALL PAVEMENT MARKING AND SIGNPOSTING IS TO BE APPROVED BY CITY OF PARRAMATTA COUNCIL TRAFFIC ENGINEER.
8. ALL SIGN POSTS IN CONCRETE TO BE HELD IN POSITION WITH V-LOCKS.
9. ALL PAINTWORK TO BE COMPLETED ON DAY OF INSTALLATION.
10. ALL LINEMARKING TO BE APPROVED WHITE THERMOPLASTIC PAINT.
11. ALL REDUNDANT SIGNS AND LINEMARKING WITHIN LIMIT OF WORKS TO BE REMOVED AS REQUIRED. RECOVERED POSTS TO BE REUSED IF PRACTICABLE.
12. ALL "TB", "TF" HOLDING LINES TO BE 300mm WIDE UNLESS NOTED OTHERWISE. REFER TO "RMS DELINEATION" SECTION 6 - TRANSVERSE MARKINGS

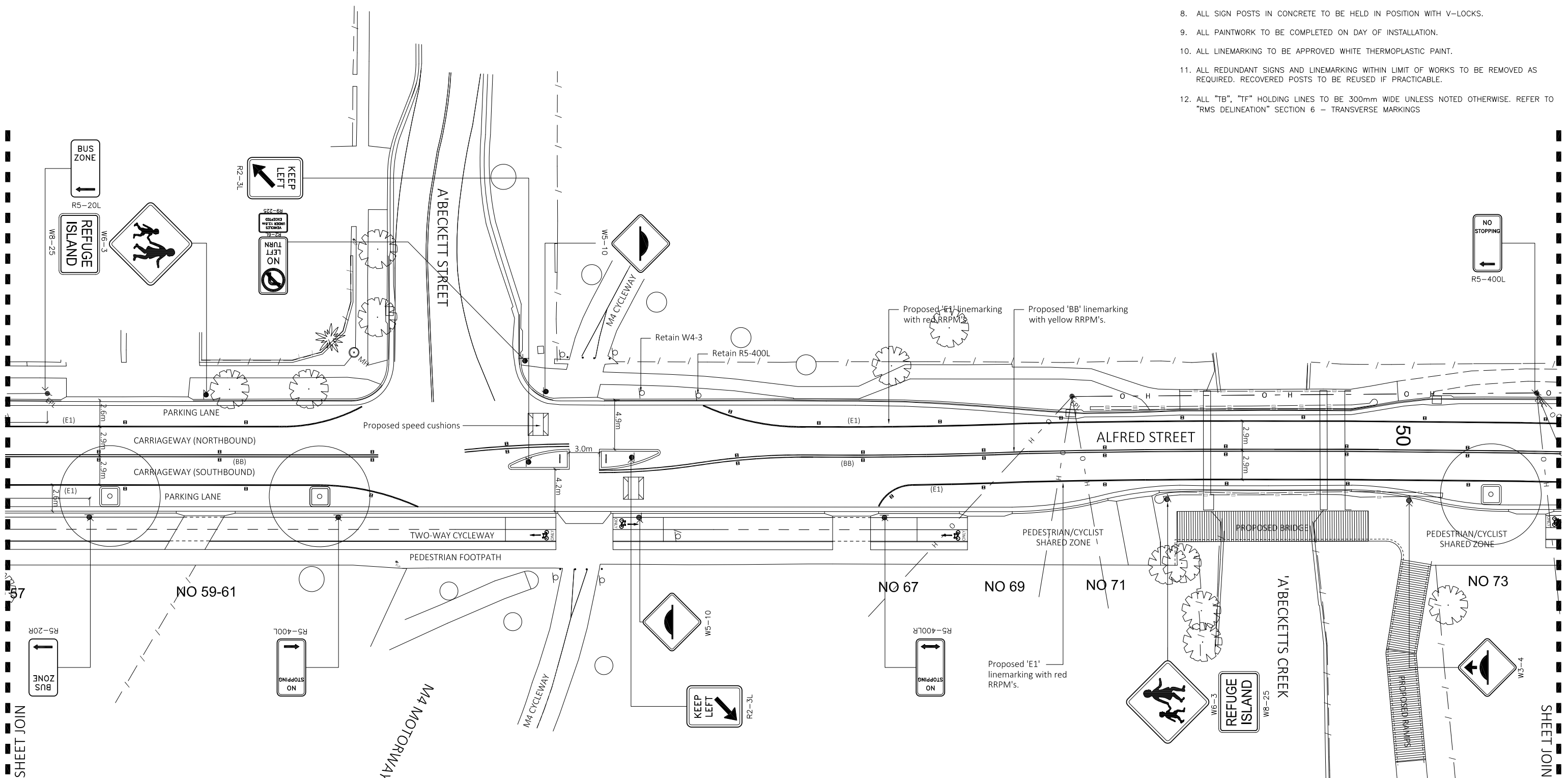

Issue:	Date:	Description:

Co-ords:	Datum:
MGA	AHD
UNLESS DETAILED ON THIS DRAWING ALL WORK SHALL CONFORM TO	

Designed:	Date:	Client Accepted:	Date:
JG			
Drawn:	Date:	Approved for Construction:	Date:
JG			
Design Approved:	Date:	Service Manager Capital Projects	

Date:	18th June 2020
Scale:	1:200 @ A1
Drawing Status:	FINAL

Project:	ALFRED STREET CYCLEWAY STAGE 1 & 2 GRANVILLE
Title:	TRAFFIC MANAGEMENT PLAN

Plan No:	17749
Sheet No:	4 of 6
Revision:	B

**NOTE:**  
 REPAINT FADED OR DAMAGED LINEMARKING AND RRPM'S AS REQUIRED OUTSIDE OF SCOPE.  
 REMOVE ALL SIGNS WITHIN SCOPE IN CONFLICT WITH PROPOSED WORKS.

**TRAFFIC MANAGEMENT NOTES:**

1. ALL PAVEMENT MARKING AND SIGNPOSTING TO BE IN ACCORDANCE WITH ROADS AND MARITIME SERVICES SUPPLEMENTS, RMS DELINEATION MANUAL, AUSTRROADS GUIDES, AUSTRALIAN STANDARDS (AS1742) AND RMS SPECIFICATIONS R141 AND R143.
2. ALL RETROREFLECTIVE RAISED PAVEMENT MARKERS TO BE IN ACCORDANCE WITH RMS SPECIFICATION R142 AND "RMS DELINEATION" SECTION 15 - RAISED PAVEMENT MARKERS.
3. ALL CONCRETE ISLAND KERB FACES ARE TO BE PAINTED WITH APPROVED REFLECTIVE WHITE PAINT IN ACCORDANCE WITH RMS SPECIFICATION R141.
4. STREET SIGNS TO BE PLACED AS DIRECTED BY SUPERVISING ENGINEER.
5. ENSURE ALL SIGNPOSTS ARE PLACED CLEAR OF EXISTING OR PROPOSED DRIVEWAYS AND CLEAR OF TREES AND OTHER STREET FURNITURE.
6. TRAFFIC CONTROL MEASURES ARE TO BE CARRIED OUT PRIOR, DURING AND AFTER CONSTRUCTION IN ACCORDANCE WITH A.S.1742.3
7. ALL PAVEMENT MARKING AND SIGNPOSTING IS TO BE APPROVED BY CITY OF PARRAMATTA COUNCIL TRAFFIC ENGINEER.
8. ALL SIGN POSTS IN CONCRETE TO BE HELD IN POSITION WITH V-LOCKS.
9. ALL PAINTWORK TO BE COMPLETED ON DAY OF INSTALLATION.
10. ALL LINEMARKING TO BE APPROVED WHITE THERMOPLASTIC PAINT.
11. ALL REDUNDANT SIGNS AND LINEMARKING WITHIN LIMIT OF WORKS TO BE REMOVED AS REQUIRED. RECOVERED POSTS TO BE REUSED IF PRACTICABLE.
12. ALL "TB", "TF" HOLDING LINES TO BE 300mm WIDE UNLESS NOTED OTHERWISE. REFER TO "RMS DELINEATION" SECTION 6 - TRANSVERSE MARKINGS

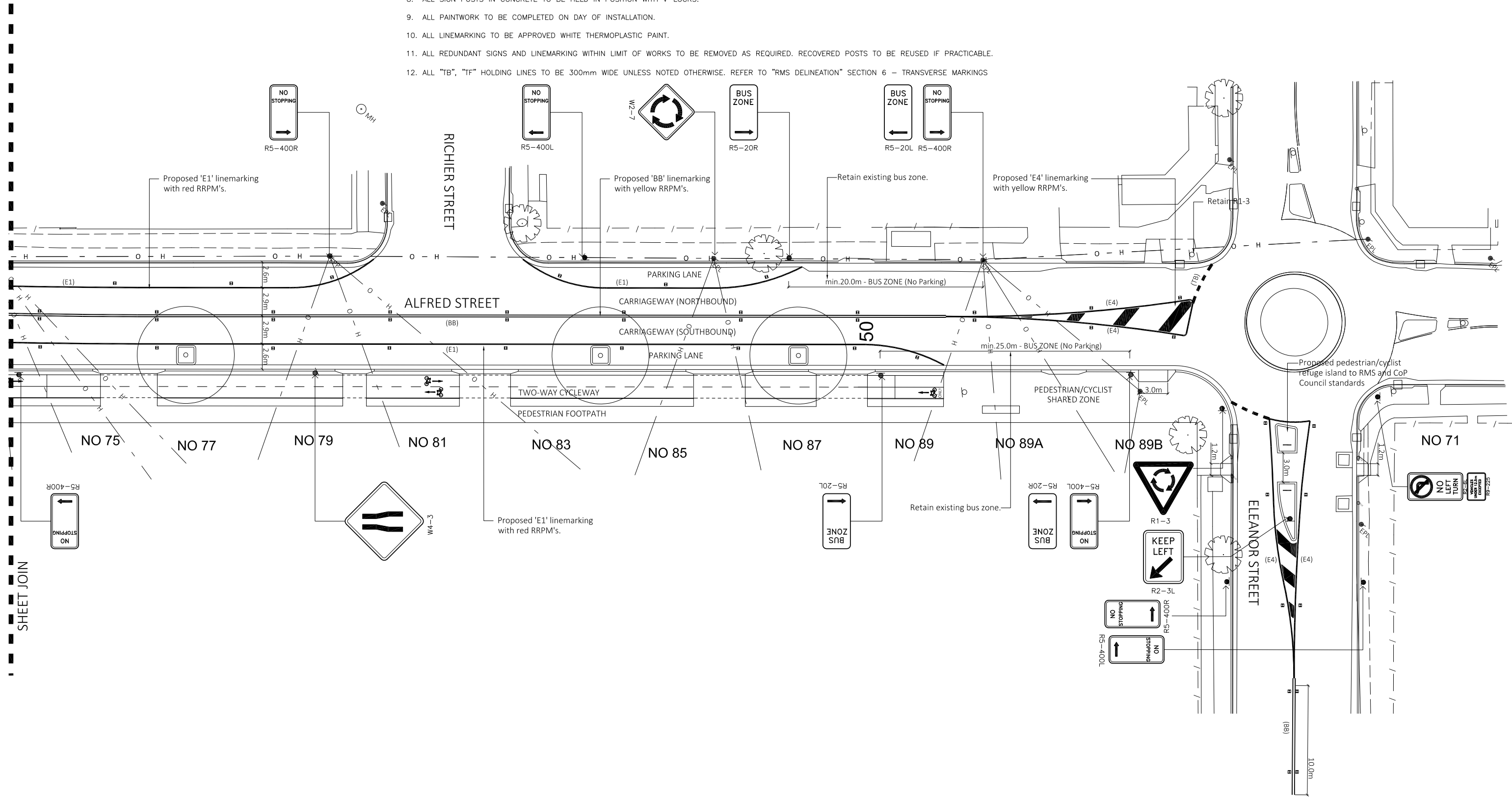

Issue:	Date:	Description:

Co-ords:	Datum:
MGA	AHD
UNLESS DETAILED ON THIS DRAWING ALL WORK SHALL CONFORM TO	

Designed:	Date:	Client Accepted:	Date:
JG			
Drawn:	Date:	Approved for Construction:	Date:
JG			
Design Approved:	Date:	Service Manager Capital Projects	

Date:	18th June 2020
Scale:	1:200 @ A1
Drawing Status:	FINAL

Project:	ALFRED STREET CYCLEWAY STAGE 1 & 2 GRANVILLE
Title:	TRAFFIC MANAGEMENT PLAN

Plan No:	17749
Sheet No:	5 of 6
Revision:	B

**TRAFFIC MANAGEMENT NOTES:**

1. ALL PAVEMENT MARKING AND SIGNPOSTING TO BE IN ACCORDANCE WITH ROADS AND MARITIME SERVICES SUPPLEMENTS, RMS DELINEATION MANUAL, AUSTRROADS GUIDES, AUSTRALIAN STANDARDS (AS1742) AND RMS SPECIFICATIONS R141 AND R143.
2. ALL RETROREFLECTIVE RAISED PAVEMENT MARKERS TO BE IN ACCORDANCE WITH RMS SPECIFICATION R142 AND "RMS DELINEATION" SECTION 15 – RAISED PAVEMENT MARKERS.
3. ALL CONCRETE ISLAND KERB FACES ARE TO BE PAINTED WITH APPROVED REFLECTIVE WHITE PAINT IN ACCORDANCE WITH RMS SPECIFICATION R141.
4. STREET SIGNS TO BE PLACED AS DIRECTED BY SUPERVISING ENGINEER.
5. ENSURE ALL SIGNPOSTS ARE PLACED CLEAR OF EXISTING OR PROPOSED DRIVEWAYS AND CLEAR OF TREES AND OTHER STREET FURNITURE.
6. TRAFFIC CONTROL MEASURES ARE TO BE CARRIED OUT PRIOR, DURING AND AFTER CONSTRUCTION IN ACCORDANCE WITH A.S.1742.3
7. ALL PAVEMENT MARKING AND SIGNPOSTING IS TO BE APPROVED BY CITY OF PARRAMATTA COUNCIL TRAFFIC ENGINEER.
8. ALL SIGN POSTS IN CONCRETE TO BE HELD IN POSITION WITH V-LOCKS.
9. ALL PAINTWORK TO BE COMPLETED ON DAY OF INSTALLATION.
10. ALL LINEMARKING TO BE APPROVED WHITE THERMOPLASTIC PAINT.
11. ALL REDUNDANT SIGNS AND LINEMARKING WITHIN LIMIT OF WORKS TO BE REMOVED AS REQUIRED. RECOVERED POSTS TO BE REUSED IF PRACTICABLE.
12. ALL "TB", "TF" HOLDING LINES TO BE 300mm WIDE UNLESS NOTED OTHERWISE. REFER TO "RMS DELINEATION" SECTION 6 – TRANSVERSE MARKINGS

**NOTE:**  
 REPAINT FADED OR DAMAGED LINEMARKING AND RRPM'S AS REQUIRED OUTSIDE OF SCOPE.  
 REMOVE ALL SIGNS WITHIN SCOPE IN CONFLICT WITH PROPOSED WORKS.

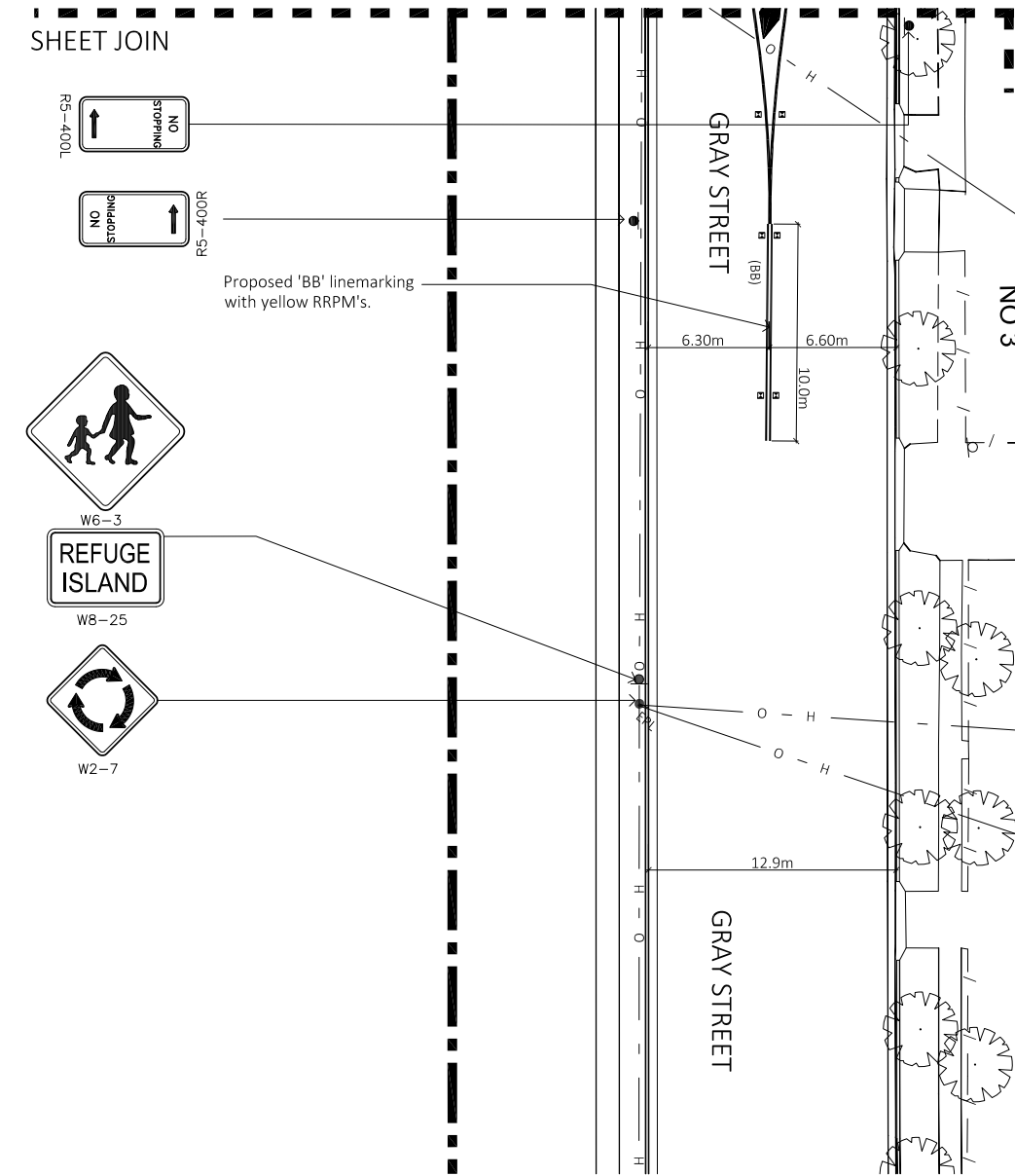

**CITY OF PARRAMATTA**



DIAL 1100 BEFORE YOU DIG



Co-ords: MGA Datum: AHD  
 UNLESS DETAILED ON THIS DRAWING ALL WORK SHALL CONFORM TO  
 AUS SPEC

Designed: JG	Date:	Client Accepted:	Date:
Drawn: JG	Date:	Approved for Construction:	Date:
Design Approved:	Date:	Service Manager Capital Projects	

Date: 18th June 2020
Scale: 1:200 @ A1
Drawing Status: FINAL

Project: ALFRED STREET CYCLEWAY STAGE 1 & 2 GRANVILLE	Plan No: 17749
Title: TRAFFIC MANAGEMENT PLAN	Sheet No: 6 of 6
	Revision: B