

DRAWING STATUS
FOR NOTIFICATION

DATE	REVISION	AMENDMENTS

WARNING
DIAL BEFORE YOU DIG

Services shown on this drawing are approximate only. The exact location is to be confirmed on site by contractor prior to commencement of work.

- GENERAL NOTES**
- DO NOT SCALE FROM THE DRAWINGS. LARGER SCALE DETAIL DRAWINGS AND WRITTEN DIMENSIONS TAKE PREFERENCE. DRAWINGS SHOULD BE READ IN CONJUNCTION WITH SPECIFICATION NOTES AND SCHEDULE OF RATES.
 - ANY DISCREPANCIES OR OMISSIONS SHALL BE REFERRED TO COUNCIL'S SUPERINTENDENT FOR A DECISION BEFORE PROCEEDING WITH THE WORKS.
 - SURVEY MARKS SHOWN THUS 4" SHALL BE RETAINED AT ALL TIMES. WHERE RETENTION IS NOT POSSIBLE THE SUPERINTENDENT MUST BE NOTIFIED AND CONSENT RECEIVED PRIOR TO THEIR REMOVAL.
 - PROTECT ALL EXISTING DRAINAGE OUTLETS, SERVICE FITS, UTILITY FEATURES AND EXISTING TREES FROM ALL DEMOLITION AND LANDSCAPE WORKS UNLESS DIRECTED OTHERWISE, BY THE SUPERINTENDENT.
 - TRAFFIC AND PEDESTRIAN MANAGEMENT, SEDIMENT AND EROSION CONTROL AND TEMPORARY TREE PROTECTION MEASURES SHALL BE UNDERTAKEN BY THE CONTRACTOR AS SPECIFIED AND TO THE SATISFACTION OF THE SUPERINTENDENT.
 - REMOVE ANY UNWANTED MATTER INCLUDING STONES EXCEEDING 50mm, BUILDING RUBBISH AND WEEDS, ETC.
 - THE CONTRACTOR SHALL MAINTAIN SERVICES AND ALL WEATHER ACCESS AT ALL TIMES TO THE ADJOINING PROPERTIES.
 - THE CONTRACTOR SHALL NOT ENTER UPON NOR DO ANY WORK WITHIN ADJACENT LANDS WITHOUT PRIOR WRITTEN PERMISSION FROM THE LAND OWNER AND / OR DIRECT INSTRUCTION FROM THE SUPERINTENDENT.
 - DAMAGE TO EXISTING PROPERTY SERVICES, FENCES, TREES AND OTHER ELEMENTS TO BE RETAINED SHALL BE RECTIFIED AT THE CONTRACTORS EXPENSE. CONTACT THE SUPERINTENDENT IMMEDIATELY.
 - THE LOCATIONS OF SERVICES SHOWN ON THESE DRAWINGS HAVE BEEN PLOTTED FROM DIAGRAMS PROVIDED BY SERVICE AUTHORITIES. THIS INFORMATION HAS BEEN PREPARED SOLELY FOR THE AUTHORITY'S OWN USE AND MAY NOT NECESSARILY BE UPDATED OR ACCURATE.
 - COUNCIL'S CAPITAL PROJECTS SECTION DOES NOT GUARANTEE THAT THE SERVICES INFORMATION SHOWN ON THESE DRAWINGS SHOW MORE THAN THE PRESENCE OR ABSENCE OF SERVICES, AND WILL ACCEPT NO LIABILITY FOR INACCURACIES IN THE INFORMATION SHOWN FROM ANY CAUSE WHATSOEVER.
 - EROSION AND SEDIMENTATION CONTROL DEVICES SHALL BE ACCORDING TO THE STANDARD RECOMMENDED BY NSW DEPARTMENT OF HOUSING BLUE BOOK.



CAPITAL PROJECTS
310 Victoria Road
Rydalmere, NSW 2116
Australia
T 02 9606 5640
F 02 9606 5905

CONSULTANTS

CLIENT
Place Services

CLIENT ACCEPTED **APPROVED FOR CONSTRUCTION**

SERVICE MANAGER CAPITAL PROJECTS

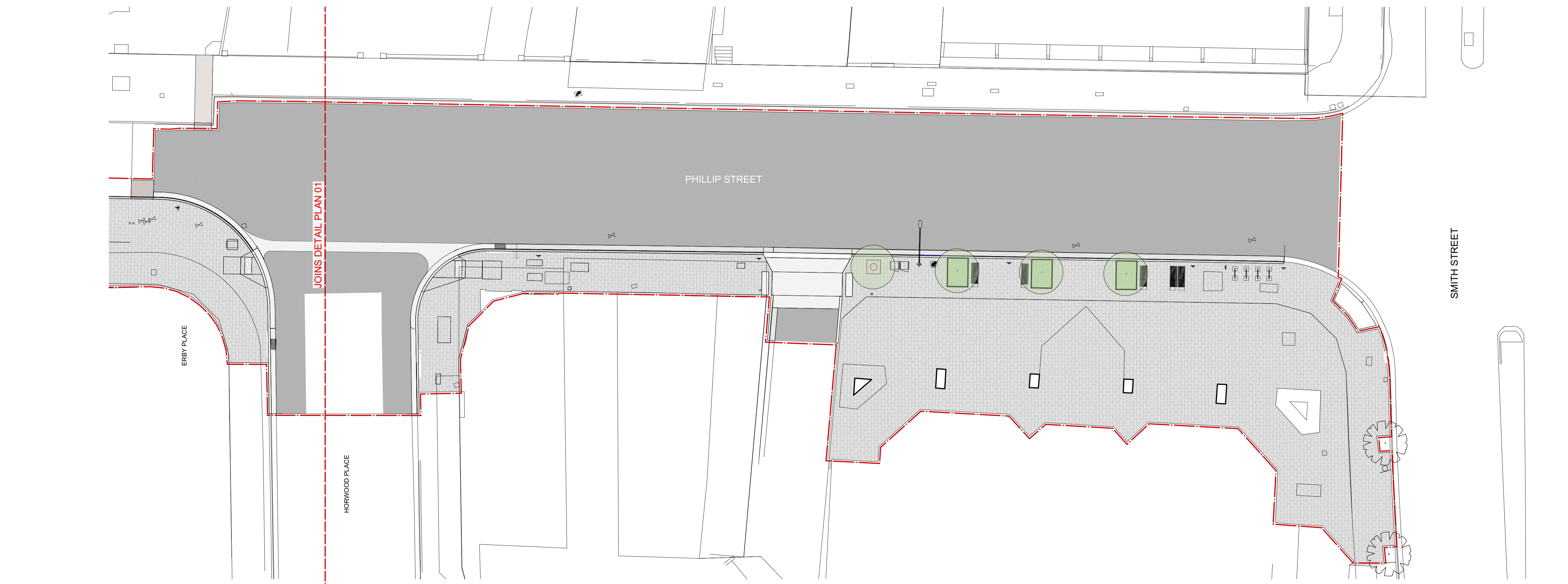

PROJECT
Phillip Street Stage 01, Parramatta

DRAWING
Notification Plan

DRAWN	CHECKED	FULL SCALE A1
TA	AC	1:200

DRAWING NO. **REVISION**

17062-SK-001 **01**

DRAWING STATUS
FOR NOTIFICATION

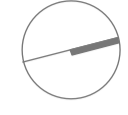

DATE	REVISION	AMENDMENTS

WARNING
DIAL BEFORE YOU DIG

Services shown on this drawing are approximate only. The exact location is to be confirmed on site by contractor prior to commencement of work.

- GENERAL NOTES**
- DO NOT SCALE FROM THE DRAWINGS. LARGER SCALE DETAIL DRAWINGS AND WRITTEN DIMENSIONS TAKE PREFERENCE. DRAWINGS SHOULD BE READ IN CONJUNCTION WITH SPECIFICATION NOTES AND SCHEDULE OF RATES.
 - ANY DISCREPANCIES OR OMISSIONS SHALL BE REFERRED TO COUNCIL'S SUPERINTENDENT FOR A DECISION BEFORE PROCEEDING WITH THE WORKS.
 - SURVEY MARKS SHOWN THUS 'A' & 'B' SHALL BE RETAINED AT ALL TIMES. WHERE RETENTION IS NOT POSSIBLE THE SUPERINTENDENT MUST BE NOTIFIED AND CONSENT RECEIVED PRIOR TO THEIR REMOVAL.
 - PROTECT ALL EXISTING DRAINAGE OUTLETS, SERVICE PITS, UTILITY FEATURES AND EXISTING TREES FROM ALL DEMOLITION AND LANDSCAPE WORKS UNLESS DIRECTED OTHERWISE, BY THE SUPERINTENDENT.
 - TRAFFIC AND PEDESTRIAN MANAGEMENT, SEDIMENT AND EROSION CONTROL AND TEMPORARY TREE PROTECTION MEASURES SHALL BE UNDERTAKEN BY THE CONTRACTOR AS SPECIFIED AND TO THE SATISFACTION OF THE SUPERINTENDENT.
 - REMOVE ANY UNWANTED MATTER INCLUDING STONES EXCEEDING 50mm, BUILDING RUBBISH AND WEEDS, ETC.
 - THE CONTRACTOR SHALL MAINTAIN SERVICES AND ALL WEATHER ACCESS AT ALL TIMES TO THE ADJOINING PROPERTIES.
 - THE CONTRACTOR SHALL NOT ENTER UPON NOR DO ANY WORK WITHIN ADJACENT LANDS WITHOUT PRIOR WRITTEN PERMISSION FROM THE LAND OWNER AND / OR DIRECT INSTRUCTION FROM THE SUPERINTENDENT.
 - DAMAGE TO EXISTING PROPERTY SERVICES, FENCES, TREES AND OTHER ELEMENTS TO BE RETAINED SHALL BE RECTIFIED AT THE CONTRACTORS EXPENSE. CONTACT THE SUPERINTENDENT IMMEDIATELY.
 - THE LOCATIONS OF SERVICES SHOWN ON THESE DRAWINGS HAVE BEEN PLOTTED FROM DIAGRAMS PROVIDED BY SERVICE AUTHORITIES. THIS INFORMATION HAS BEEN PREPARED SOLELY FOR THE AUTHORITY'S OWN USE AND MAY NOT NECESSARILY BE UPDATED OR ACCURATE.
 - COUNCIL'S CAPITAL PROJECTS SECTION DOES NOT GUARANTEE THAT THE SERVICES INFORMATION SHOWN ON THESE DRAWINGS SHOW MORE THAN THE PRESENCE OR ABSENCE OF SERVICES, AND WILL ACCEPT NO LIABILITY FOR INACCURACIES IN THE INFORMATION SHOWN FROM ANY CAUSE WHATSOEVER.
 - EROSION AND SEDIMENTATION CONTROL DEVICES SHALL BE ACCORDING TO THE STANDARD RECOMMENDED BY NSW DEPARTMENT OF HOUSING 'BLUE BOOK'

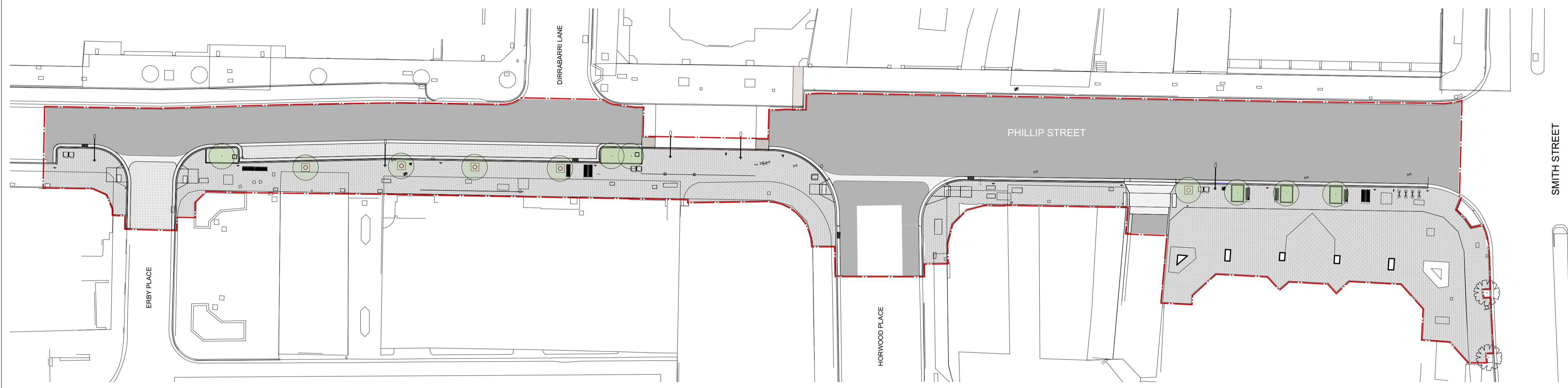

CAPITAL PROJECTS
310 Victoria Road
Rydalmere, NSW 2116
Australia
T 02 9806 5640
F 02 9806 5905

CONSULTANTS

CLIENT
Place Services

CLIENT ACCEPTED	APPROVED FOR CONSTRUCTION

SERVICE MANAGER CAPITAL PROJECTS

PROJECT
Phillip Street Stage 01, Parramatta

DRAWING
Notification Plan

DRAWN	CHECKED	FULL SCALE A1
TA	AC	1:350

DRAWING NO.
17062-SK-001

REVISION
01